

D

C

B

A

8  
7  
6  
5  
4  
3  
2  
1

8  
7  
6  
5  
4  
3  
2  
1

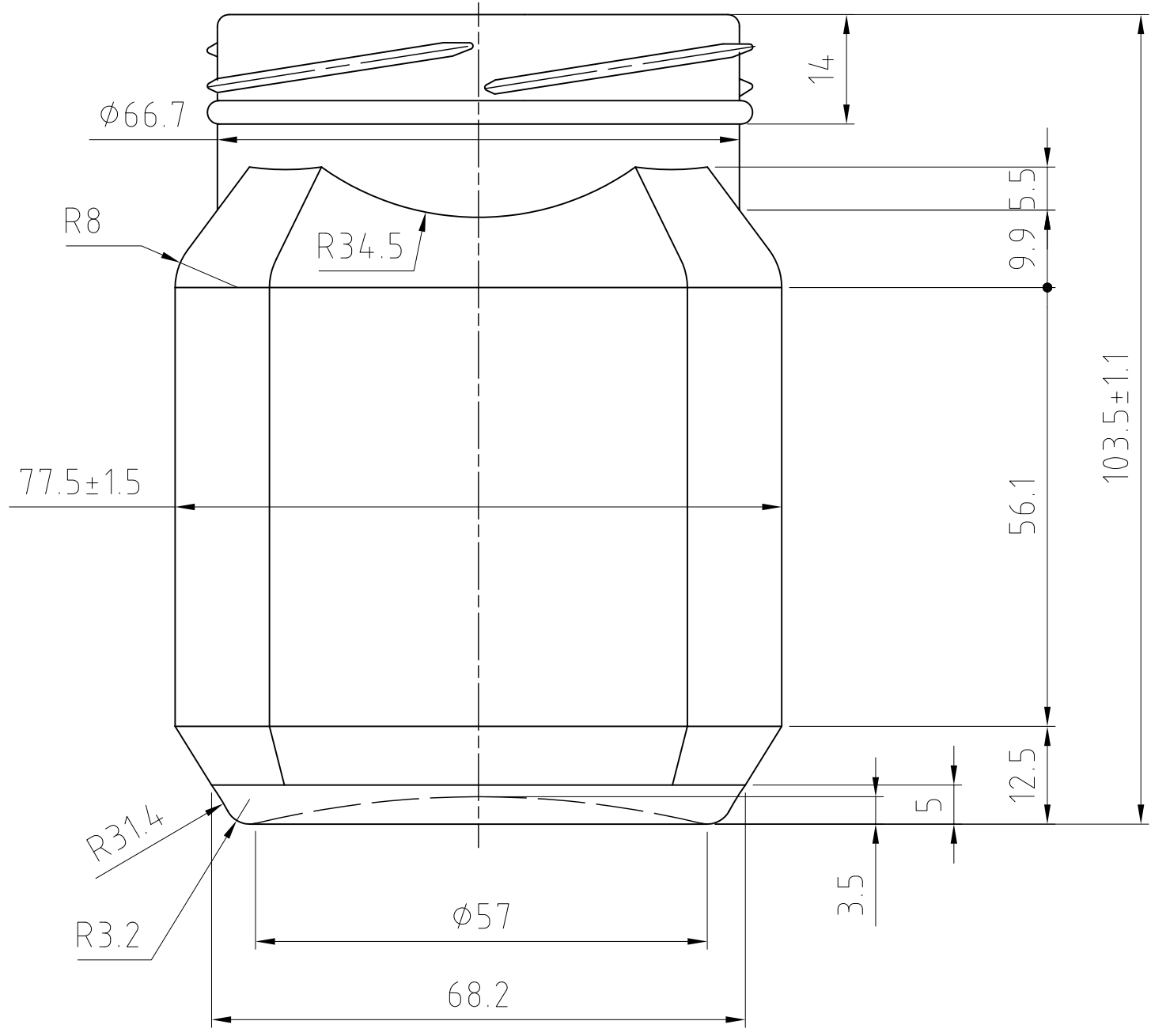
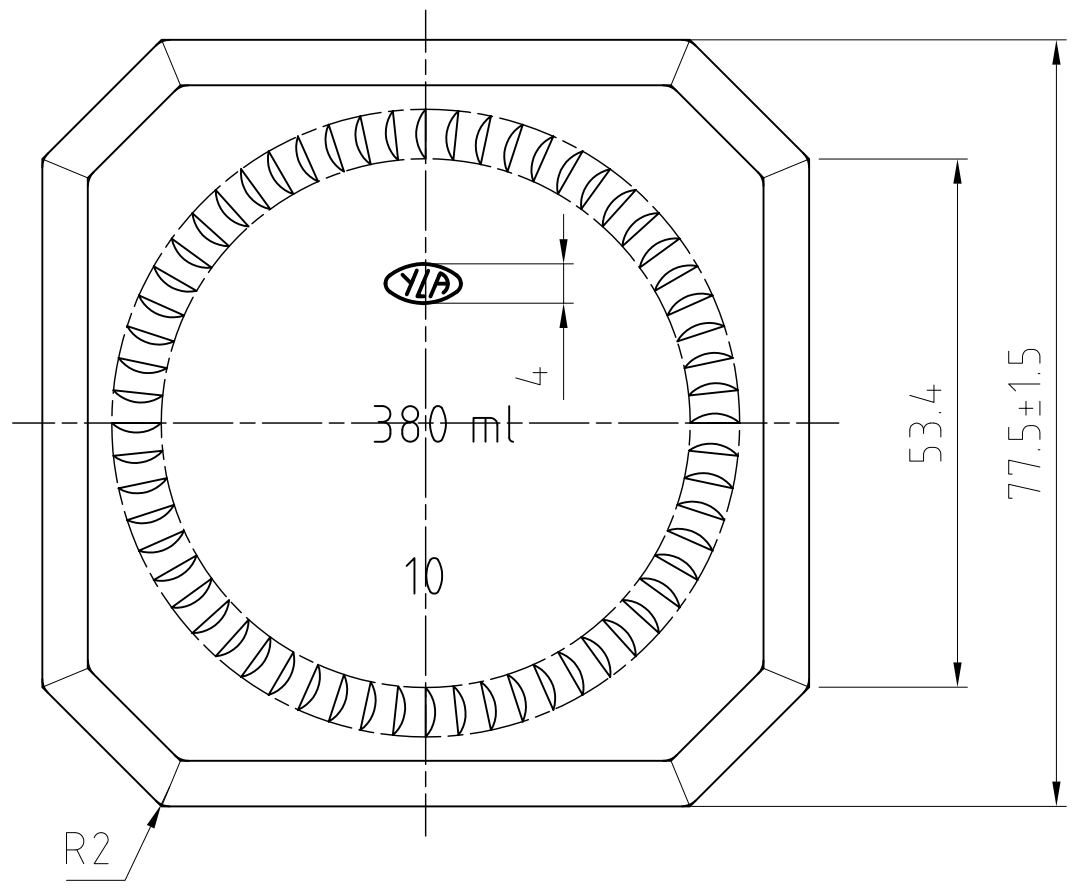

On the base of jar 22274

NAME	DATE	REVISIONS	MOLD NO.		A3	DRUJBA Glassworks S.A. A Member of Yioula Group	
			FINISH	FIN 704			
			CAP. BRIMF.		MACHINE	SG 4 1/4"	BOTTLE
			CAP. FILLPT.	380 ± 6ml	DATE	27/12/2005	38cl JAR " BRUSCHETA "
			FILL LINE		DRAWN	Stanchev	CAT.No & DWG No
			WEIGHT	300 ± 11.5gr	CHECKED	Angelov	8011704
			COLOR	FLINT	CONFIRMED		SHEET: 1/1 SCALE: 1:1

D

C

B

A

1

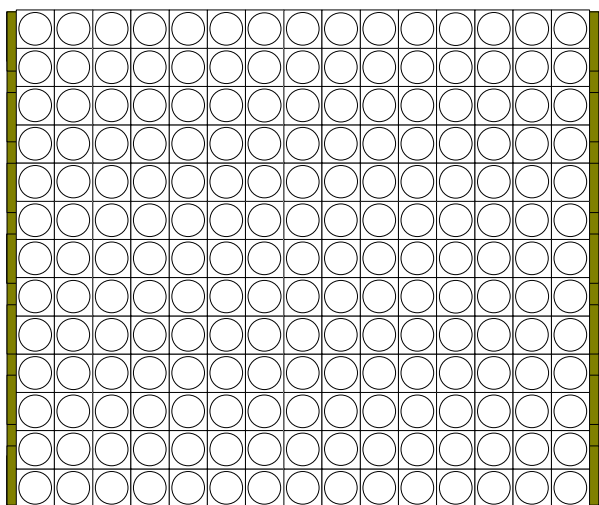

1200.0

1007.5

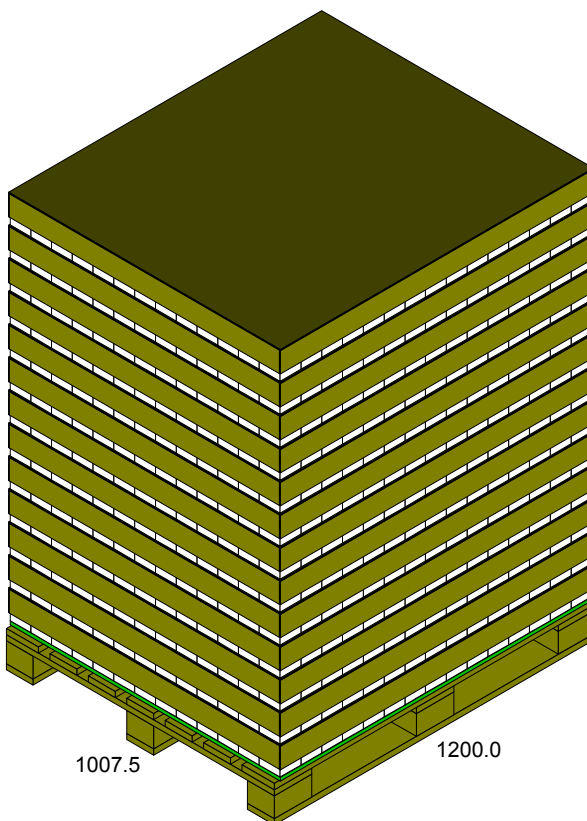
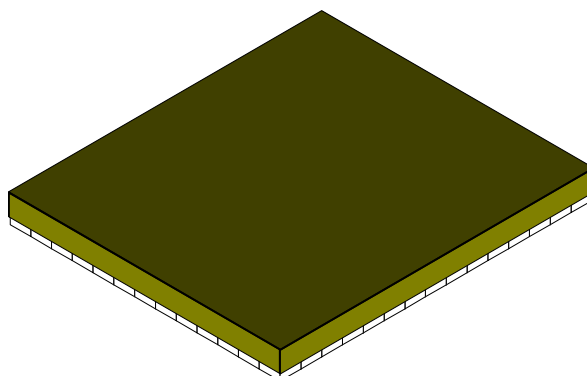

1655.4

1007.5

1200.0

**DRUJBA PALLET 09 1200.0x1000.0x134.0**

	Bottle (ID)	Bottle (OD)	UnitLoad (Incl. Pal)
Ln:	77.50 mm	77.50 mm	1200.0 mm
Wd:	77.50 mm	77.50 mm	1007.5 mm
Ht:	103.50 mm	103.50 mm	1655.4 mm
Net:		300.00 g	819.000 kg
Grs:		0.00 g	22.000 kg
Cube:	0.558 l	0.6 l	2.0014 m3

Height Vert

Bottle:	2730
Area Efficiency:	97.60 %
Cubic Efficiency:	76.14 %
Cases per layer:	195
Layers/load:	14
Pattern:	Column

Notes: THE WOODEN PALLET IN USE IS SPECIALLY FUMIGATED